

124-510 CST

ductile iron flanged ball valves



CE

altecnic

124-510 CST ductile iron flanged ball valve



Function

The Altecnic 124-510 CST ductile iron flanged ball valves are suitable for heating and air conditioning (HVAC), district heating, water treatment, compressed air, industrial and agricultural applications.

The valve has a ductile iron, split body with a floating ball in reinforced PTFE seats.

The valve is a full bore design to reduce turbulence and pressure losses through the valve.

The valves have an anti blow-out proof stem with a dual 'O' ring stem seal for improved stem sealing.

The valves has a mounting flange complying the BS EN ISO 5211 for various actuator options.

The valves are available with various accessories please refer to the Altecnic Technical Department for availability.

Product Range

Ref No	Size	Operation
124-5100 CST	DN50	Lever
124-5101 CST	DN65	Lever
124-5102 CST	DN80	Lever
124-5103 CST	DN100	Lever
124-5104 CST	DN125	Lever
124-5105 CST	DN150	Lever

Construction Details

Component	Material	Grade
Body	Ductile iron	BS EN 1563 EN JS1040
Ball	Brass	BS EN 12164 CW617N
Stem	Brass chrome plated	BS EN 12164 CW617N
Seat	PTFE	carbon reinforced
Thrust ring	PTFE	
'O' rings	NBR	
Lever	Carbon steel	epoxy coated

Dimensions

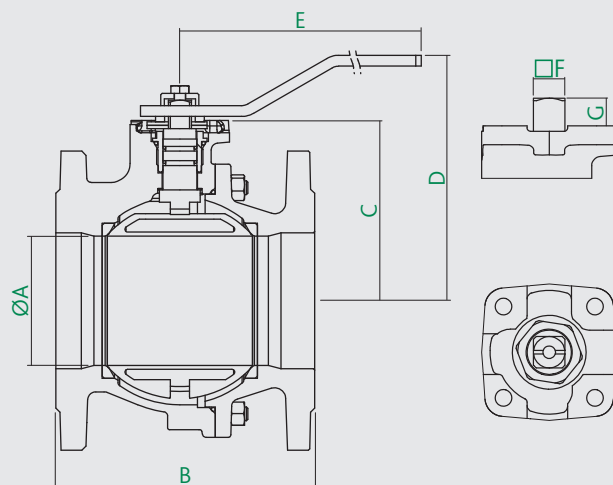

A	B	C	D	E	F	G	kg
50	150	87	135	230	14	13.5	9.7
63	170	95	143	230	14	13.5	12.2
76	180	118	165	280	17	15	16.7
95	190	132.5	180	360	17	15	22.2
120	200	165	225	520	22	21	35.8
145	210	182.5	243	520	22	21	46.6

Technical Data

Face to face:	BS EN 558-1
Design:	BS EN 1983 & BS EN 12516
Flanged PN16:	BS EN 1092-1
All valves tested in accordance with:	BS EN 12266 cat A
Working temperature range:	-10 to 100°C
Suitable for end of line service:	See Below
Maximum pressures:	
Between flanges:	16 bar
End of line:	10 bar

Important

This valve is **NOT** suitable for flow regulation.

NOT suitable for steam

DN125 & DN150 are not suitable for end of line service with hazardous gases (67/548/EEC).

Operating torque

DN50	DN65	DN80	DN100	DN125	DN150
20 Nm	40 Nm	70 Nm	100 Nm	180 Nm	250 Nm

124-510 CST ductile iron flanged ball valve

Hydraulic Characteristics and Kv Values

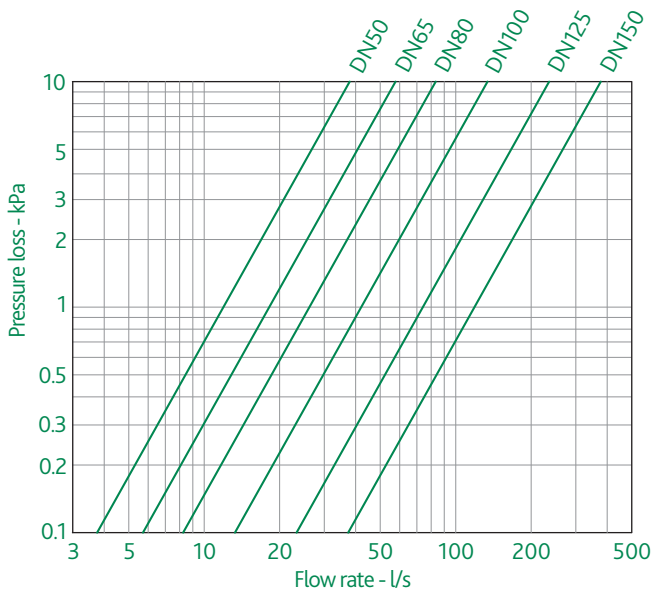

DN	50	65	80	100	125	150
Kv - m ³ /hr	435	672	947	1508	2633	4261

The chart for flowrate and Kv values were made using water.

Accessories

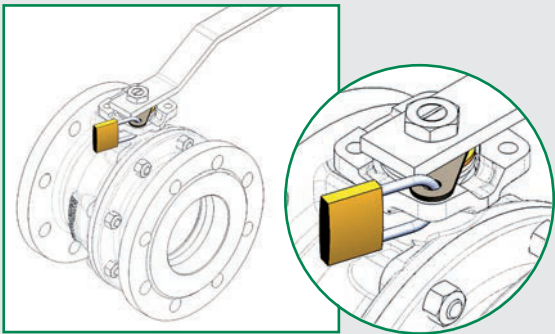

Lockable lever kit

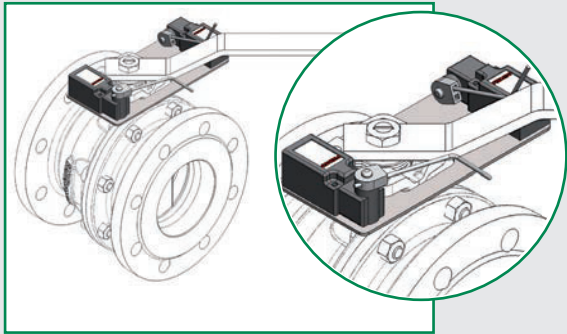

Limit switch kit for ON/OFF position indication

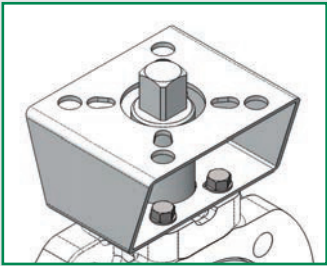

Actuator mounting kit

124-510 CST ductile iron flanged ball valve

Accessories Continued



Manual gear operator



Electric actuator



Pneumatic actuator

© Patents & Design Altecnic 2020

Altecnic Ltd retains all rights (including patents, designs and copyrights, trademarks and any other intellectual property rights) in relation to all information provided on or via the website, brochures or any other documents, including all texts, graphics and logos, contained on the website, in brochures or in any other documents published in the name of or on behalf of Altecnic Ltd in any form, without prior written consent of Altecnic Ltd.

Altecnic Ltd Mustang Drive, Stafford, Staffordshire ST16 1GW

T: +44 (0)1785 218200 E: sales@altecnic.co.uk

Registered in England No: 2095101

altecnic.co.uk

AL 388 21-10-20

E & O.E

© Altecnic Limited. 2020

ALTECNIC™

altecnic